

Since 1995, we focus on switches

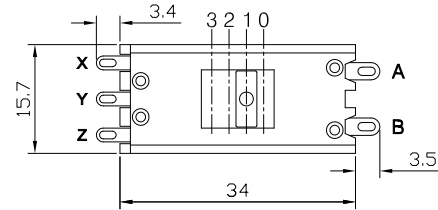

XN-14A-1405-AA1

- Single Pole; 4 Position
- Ratings:
10A 125VAC; 5A 250VAC; UL
5A 250VAC; TUV, CQC
- Features:
Soldering Terminal

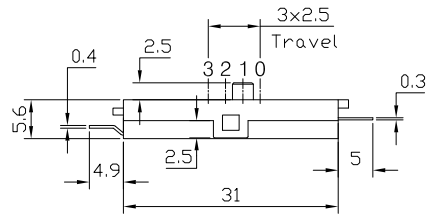

XN-14A-1405-AA1

Single Pole _____ Actuator Code
 4 Position _____ Reed Code
 Current at 250VAC _____ Terminal Code

Actuator Options

POSITION	CIRCUIT
0	
1	
2	
3	

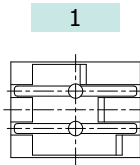

POSITION	CIRCUIT
0	
1	
2	
3	

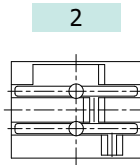

POSITION	CIRCUIT
0	
1	
2	
3	

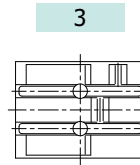

POSITION	CIRCUIT
0	
1	
2	
3	

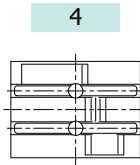

POSITION	CIRCUIT
0	
1	
2	
3	

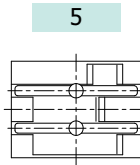

POSITION	CIRCUIT
0	
1	
2	
3	

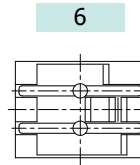

POSITION	CIRCUIT
0	
1	
2	
3	

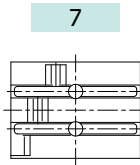

POSITION	CIRCUIT
0	
1	
2	
3	

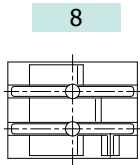

POSITION	CIRCUIT
0	
1	
2	
3	

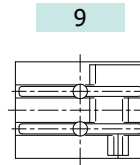

POSITION	CIRCUIT
0	
1	
2	
3	

